

Listening Assistant Manual

Jan. 26, 2026

This manual is copyrighted by Mirai Translate, Inc.

The information and products described in this manual may not be repurposed or reproduced in whole or in part without obtaining permission in advance from Mirai Translate, Inc.

The information in this manual is disclosed to users only, and any distribution to third parties requires obtaining permission in advance from Mirai Translate, Inc.

Introduction

About this manual

Intended audience

It is assumed that readers have a basic understanding of PCs and web browsers, and how to operate them.

This manual describes functions provided by Listening Assistant, and how to use these functions.

Manual conventions

- The following conventions are used for explanatory content such as handling restrictions and precautions.

Important

- A usage precaution or limitation. This should be read carefully to avoid trouble.

Note

- Information useful for operation, or additional information. It is recommended to read this.

- Numbers (such as ❶ [1]) are shown on the screen to explain how to use the screen.
- Brackets ([]) are used to indicate items displayed on the screen and items for the user to manipulate.
- Parentheses (“ ”) are used to indicate information to enter or references in manuals.
- The screens included in this manual were captured using Google Chrome.

Related manuals

| Title | Description |
|---------------------------|---|
| FLaT User Manual | This describes how to use the translation tool. It is meant for general users. |
| FLaT Administrator Manual | This describes how to use the resource management and user management functions. It is meant for group leaders and administrator users. |

Guarantee and disclaimer

- The operation guarantee is based on the manual corresponding to the product version. Operations based on an older manual shall not be covered by the operation guarantee.
- The operation of the product may differ from what is described in the manual due to product improvements or changes. Although this manual has been prepared with utmost care, please contact us if anything appears out of the ordinary.

Trademarks

Company names and product names in this manual are the trademarks or registered trademarks of their respective companies.

Table of Contents

| | |
|---|-----------|
| Introduction | 1 |
| About this manual | 1 |
| Related manuals | 1 |
| Guarantee and disclaimer..... | 2 |
| Trademarks | 2 |
| Table of Contents | 3 |
| Overview | 4 |
| Features of Listening Assistant..... | 4 |
| Operating environment | 4 |
| Main specifications..... | 5 |
| Signing In and Signing Out | 6 |
| Signing in | 6 |
| Signing out | 8 |
| Reference: Resetting your password | 9 |
| Listening Assistant | 11 |
| Main screen | 11 |
| Setting Listening Assistant..... | 12 |
| Setting Listening Assistant Display | 15 |
| Improving speech recognition accuracy (phrase list function) | 16 |
| Starting speech translation | 19 |
| Stopping speech translation | 21 |
| Appendix 1 | 22 |
| Information on capturing audio from web conference applications (for Windows) | 22 |
| Appendix 2 | 24 |
| Frequently asked questions | 24 |

Overview

Features of Listening Assistant

Listening Assistant is a cloud service that recognizes speech in video conferences held over the Internet and displays translated text using a web browser.

Operating environment

The following web browsers are supported.

PC

- Google Chrome (Windows/macOS)
- Microsoft Edge (Windows/macOS)

Smartphone/tablet

Currently not supported.

Main specifications

Supported languages

- Japanese, English, Chinese (Simplified)
- The following languages are available as β versions
 - Korean, Thai, Vietnamese, Indonesian, Spanish, French, Portuguese

Language direction

- Translate from all languages (supported by LA) to the selected language
- Bidirectional between two configured languages
 - Ex: English ↔ Japanese

Usage limitations

| Item | Description |
|------------|--|
| Time limit | <ul style="list-style-type: none">• The service may be used continuously for two hours at a time. <p>Note</p> <ul style="list-style-type: none">• To use the service for a three-hour meeting, click “Stop” at any time within two hours (for example after one hour and 50 minutes), and then click “Start” again. If you need the recognized text/audio file saved when stopping, download the file before clicking the “Start” button again. |

Signing In and Signing Out

This section describes the procedure for accessing Listening Assistant.

Refer to this manual or the FLAT User Manual for information on resetting your sign-in password if you have forgotten it. Refer to the FLAT User Manual for information on resetting an account that has been locked.

Signing in

1. Access the sign-in URL.

Notes

- Contact your administrator for the sign-in URL.
- The following screen may be displayed when accessing the sign-in URL. You should normally be redirected automatically (the screen will switch), but this may not occur depending on your Chrome settings. In such a case, click the “Click here if not automatically redirected” link on the screen.



2. Enter your email address and password, and then click [Sign in].

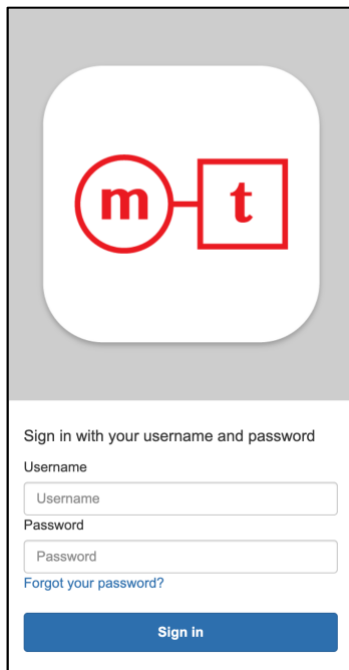

The following screen is displayed only for the first time of start up. Select “Allow.”



Important

- Be sure to select “Allow” here. If “Allow” is not selected at this time, use of the microphone will be blocked automatically from then on.
- After logging in, the following screen may appear. Please wait for a while as the process is progressing. If the screen does not change after a while, click the Reload button.

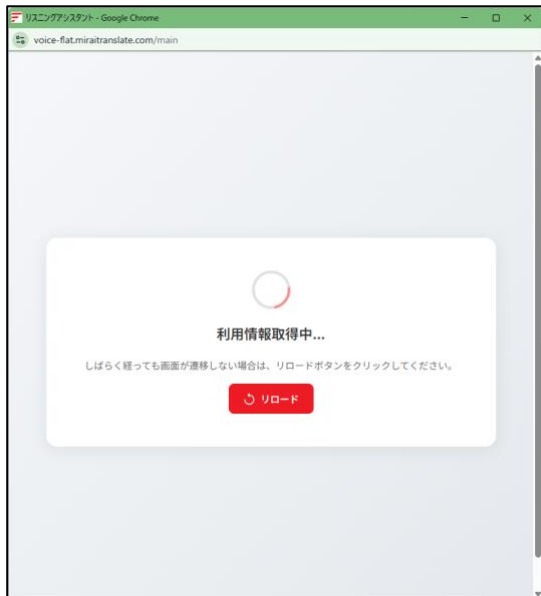

Signing out

1. Click ≡ (hamburger menu).



2. Click “サインアウト(Sign out).”



Reference: Resetting your password

1. You can reset your login password if you have forgotten it. Click link ❶.

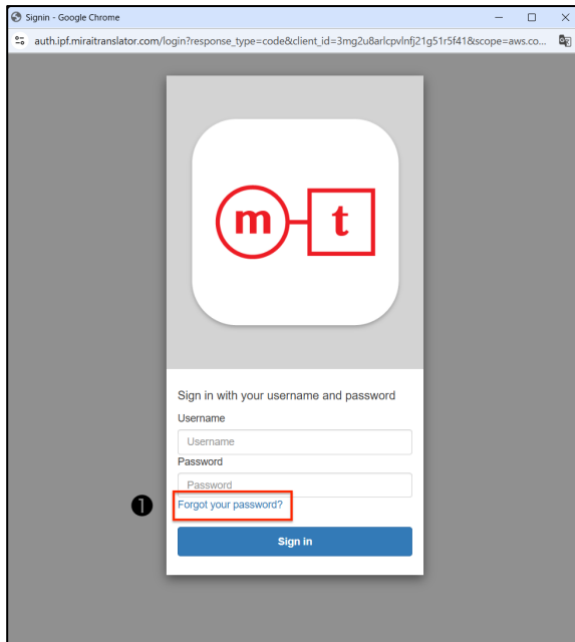

2. Enter your registered email address in the box on the following screen. You will be redirected to a screen asking you to enter a six-digit code. This code will be sent to your registered email address.

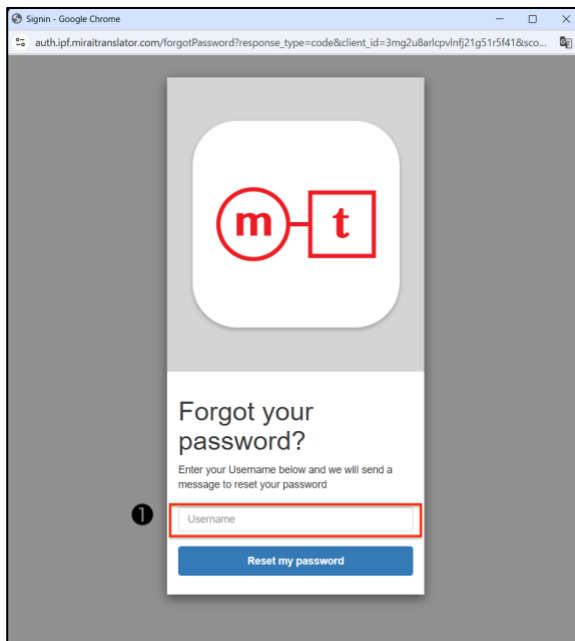

3. Enter the six-digit code you received in box ❶, and then enter your new password in box ❷ on the following screen.

Signin - Google Chrome
auth.jp.f.miraitranslator.com/confirmForgotPassword?response_type=code&client_id=3mg2u8aricpvlnj21g51r5f...

We have sent a password reset code by email to *****@m****. Enter it below to reset your password.

Code

New Password

Enter New Password Again

Change Password

4. Once you have entered this information, click button ❶.

Signin - Google Chrome
auth.jp.f.miraitranslator.com/confirmForgotPassword?response_type=code&client_id=3mg2u8aricpvlnj21g...

We have sent a password reset code by email to *****@m****. Enter it below to reset your password.

Code

New Password

Enter New Password Again

- ✓ Password must contain a lower case letter
- ✓ Password must contain an upper case letter
- ✓ Password must contain a number
- ✓ Password must contain at least 6 characters
- ✓ Passwords must match
- ✓ Password must not contain a leading or trailing space

Change Password

Listening Assistant

Listening Assistant is a cloud service that recognizes speech in video conferences held over the Internet and displays translated text using a web browser.

Main screen

1. The main screen is displayed after successfully signing in.



Setting Listening Assistant

1. Click ❶ to display the settings menu.



2. Use ❶ to select the usage mode.



Notes

- “オンライン (Online)” is intended for use in such situations as participating in web conferences and watching videos such as YouTube and webinars.
- “オフライン (Offline)” is intended for use in situations such as attending meetings in person or translating sound sources for lectures in person.
- When “オフライン (Offline)” is set, the sound generated from the PC is not recognized by the listening assistant.

3. Select the translation direction in ❶ by selecting the type of translation.

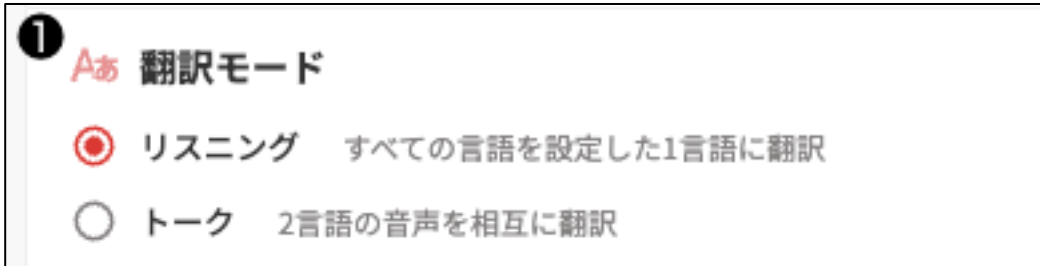

Notes

- “リスニング (Listening)” mode translates from all the languages supported by LA to the selected language.
- “トーク (Talk)” mode translates between the two languages you specified.
-

4. Set the language.

➤ Listening Mode



Notes

- Select one language for translation when using the Listening Mode.

➤ Talk Mode

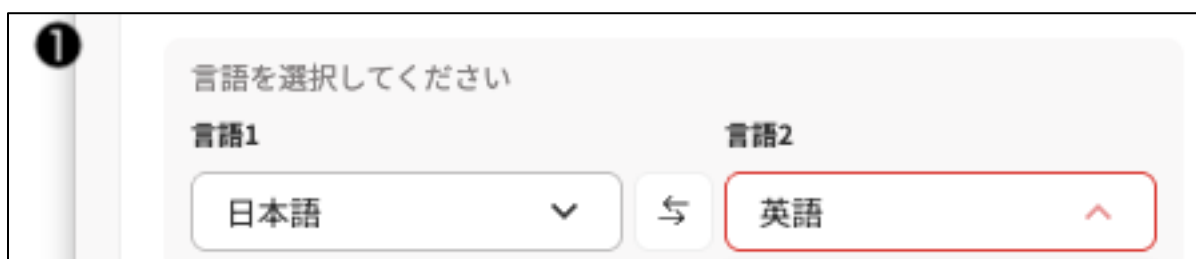

Notes

- Set any 2 languages in Talk Mode.
- For each of the two specified languages, there is no difference in functionality whether you place the language in the left or right column.

Important

- If you want to change the translation direction while using the service, you will need to first stop the service before changing the translation direction.

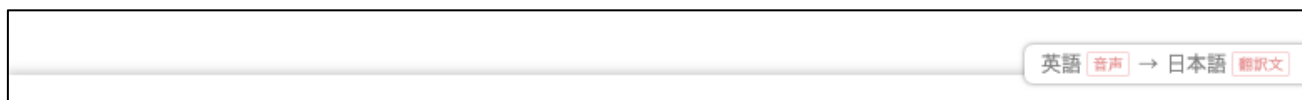

5. Set the microphone.

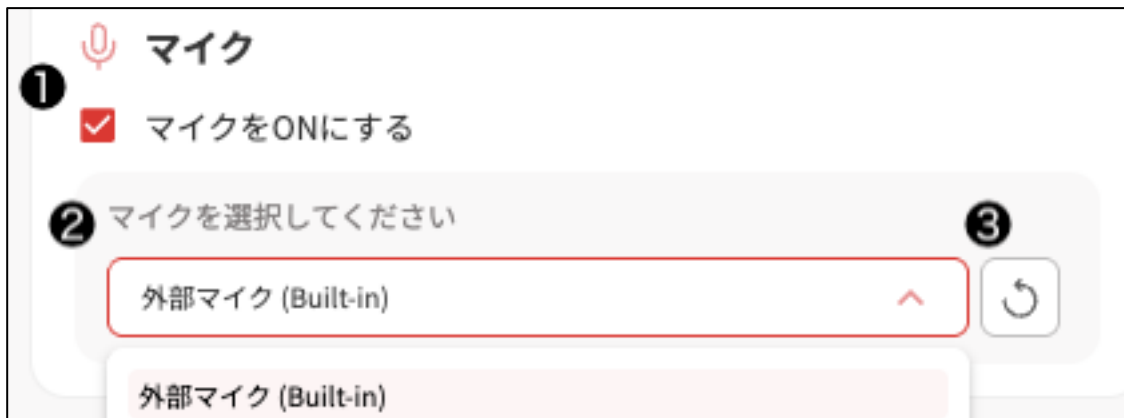

Notes

- For translating the speech of a user using Listening Assistant online, enable the microphone with ❶.
- You can select microphone by using pull-down ❷.
- Click button ❸ when the device connected to the PC does not appear in the pull-down (such as when connecting/disconnecting the microphone after starting the Listening Assistant).

Setting Listening Assistant Display

1. The display setting menu appears when you hover over the Listening Assistant display window as shown below.



2. Change the setting from the icon of each setting item

➤ Changing Text Size



➤ Changing Text Display



➤ Changing the screen orientation

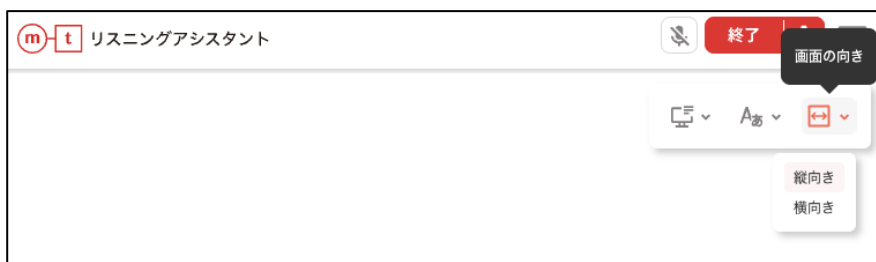

Notes

- The display setting disappears automatically when you move the mouse away from the Listening Assistant window.

Improving speech recognition accuracy (phrase list function)

1. Click ❶ to display the settings menu.

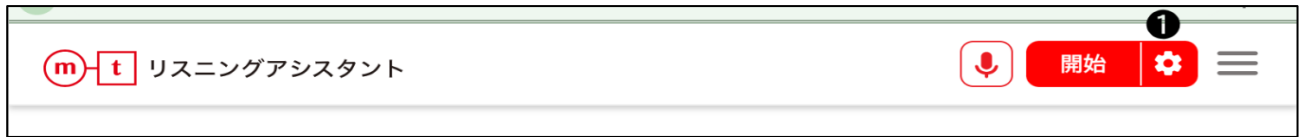

2. Click ❶ "Save/edit."



3. Select the applicable language in ❶, enter the phrase to register (for example, “Mirai Translator”) in the box ❷, and then click “Register” ❸ to register the phrase. Phrases that have already been registered are displayed in the list ❹.



4. To delete a phrase, click the “Trash can icon” ❶ next to the phrase to delete.



Important

- A maximum of 500 words and phrases can be registered to the phrase list for each language (“Japanese,” “English,” and “Chinese”).
- The phrase list function can be used to register phrases only when using the portrait layout. If the layout is set to landscape, change it to the portrait setting.
- An error will occur and registration will fail in the following situations when registering in “Japanese.”
 - When using a combination of characters other than single-byte alphanumeric characters and double-byte hiragana, katakana, and kanji characters
 - When a single-byte space is entered
 - When a double-byte space is entered
- An error will occur and registration will fail in the following situations when registering in “English.”
 - When characters other than single-byte alphanumeric characters are entered
 - When consecutive spaces are entered
- An error will occur and registration will fail in the following situations when registering in “Chinese.”
 - When using a combination of characters other than single-byte alphanumeric characters and double-byte kanji characters
 - When a single-byte space is entered
 - When a double-byte space is entered
- Note the following points when registering in “Chinese.”
 - Listening Assistant assumes the use of simplified Chinese. Traditional Chinese can also be registered, but this may not function properly.
- Note the following points when registering in other languages (Korean, Thai, Vietnamese, Indonesian, French, Spanish, Portuguese).
 - Consecutive lambda space
- An error will occur and registration will fail in the following situations, regardless of the language direction.
 - When an empty character string or no value is entered
 - When registering a phrase that has already been registered (duplicate registration)
 - When attempting to register a phrase when the maximum number of phrases have already been registered
 - When registering a phrase containing 128 characters or more

Starting speech translation

1. Click “Start” ❶.

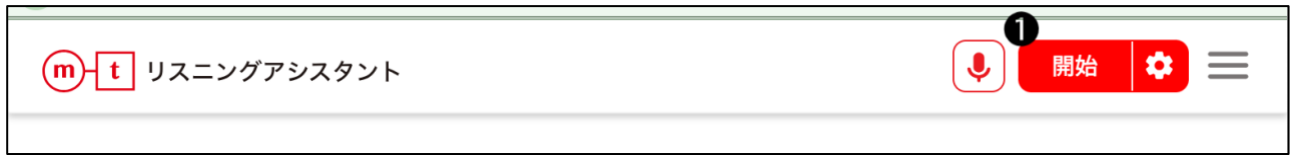

2. Select the audio source to capture in ❶, and then click “Share” ❷.



Important



- This step is not required to use Listening Assistant "オフライン(Offline)"
- On Windows, select “Full screen.”
- On a Mac, select “Chrome tab.”
- Ensure that audio sharing is turned ON.

Notes

- Selecting “Chrome tab” will cause audio to be captured from the selected Chrome tab. Use this to translate speech from a Zoom meeting started on Chrome, or a YouTube video.
- Do not select “Window,” as doing so will prevent sharing audio.
- Selecting “Full screen” will cause all audio generated from the PC to be captured. Use this to translate speech from the Zoom or Teams application. (“Full screen” is available only on Windows.)
- On a Mac, audio is captured using the sharing function provided by Chrome. When using Zoom or Teams, make sure to run the application in Chrome instead of using the actual application.

An example of the screen during use is shown below.



3. Audio from the microphone can be muted by clicking the  "Mute" button .

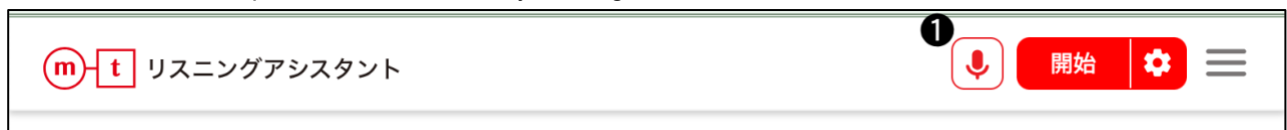

Important

- The mute function is available only when "Speak also" is selected as the usage mode.

Stopping speech translation

1. Click ❶ to stop.

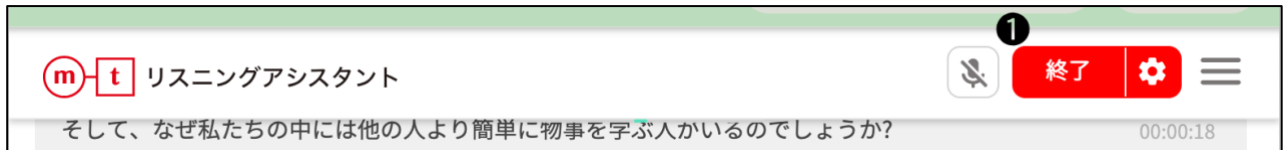

2. Clicking "Download" ❶ will download a text/audio file.

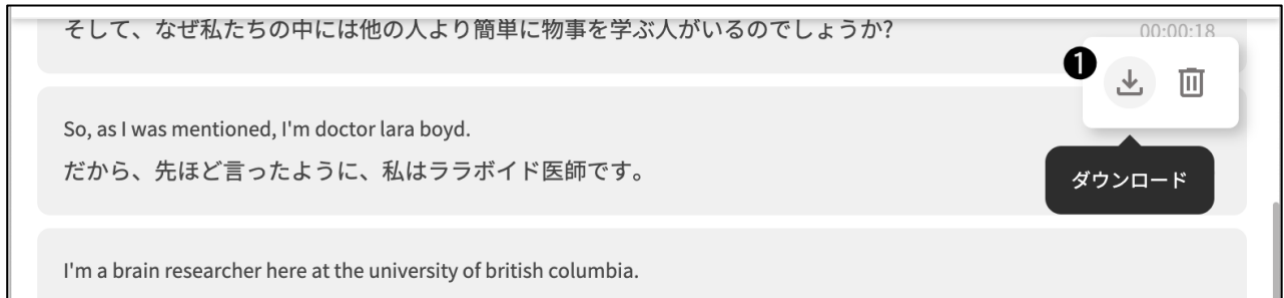

Important

- Text for both Japanese and English languages can be downloaded.

3. Clicking "Clear history" ❶ will clear any data as of the time when translation was stopped.

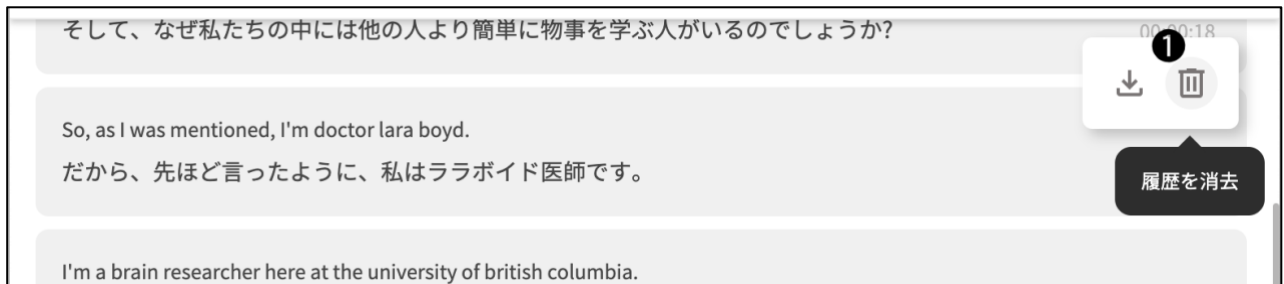

Important

- Once clicked, "Clear history" will also clear any saved text/audio files, and it will no longer be possible to download them again.

Appendix 1

Information on capturing audio from web conference applications (for Windows)

Important

- Following is some important information about using Windows.

1. If using the Teams application, ensure that the device settings in the Teams application match the system device settings.

Windows 11 sound settings

Teams device settings

Device setup procedure

Set to the same devices.

If this was set to "Custom setup," change this so that the speaker and microphone are the same as the devices selected in the system settings.

2. If using the Zoom application, ensure that the device settings in the Zoom application match the system device settings.

The image displays two side-by-side screenshots. The left screenshot, titled "Windows 11 sound settings", shows the Windows Settings application in Japanese. Under "出力" (Output), "Headphone" is selected and circled in blue. Under "入力" (Input), "Headset Microphone" is selected and circled in blue. A red box with the text "Set to 'Same as system.'" has two red arrows pointing to the "Headphone" and "Headset Microphone" selections. The right screenshot, titled "Zoom microphone/speaker settings", shows the Zoom application's settings. Under "マイク" (Microphone), "システムと同じ (Headset Microphone (Realtek(R) Audio))" is selected and circled in orange. Under "スピーカー" (Speaker), "システムと同じ (Headphone (Realtek(R) Audio))" is selected and circled in orange. A blue box with the text "Click '^' to configure." has a blue arrow pointing to the '^' icon at the bottom of the Zoom settings panel.

Appendix 2

Frequently asked questions

| Question | Answer |
|---|---|
| I cannot sign in. | Your account (email address) might not be registered. Contact your company administrator. |
| Speech recognition/translation does not start even after pressing "Start." | If speech recognition/translation does not start even after pressing "Start," there are several possible causes. Check the following settings again. <ul style="list-style-type: none">• Ensure that you have the appropriate sharing settings configured when starting.• If using Mac OS, selecting anything other than "Chrome tab" will prevent speech from being recognized/translated. |
| When using the "Speak also" usage mode, recognition/translation of my own voice does not start. | The microphone may not be configured correctly. Ensure that the microphone is configured correctly on the screen used to select the usage mode. |
| Speech is not recognized. | Check the following. <ul style="list-style-type: none">• Ensure that your device settings for Teams or Zoom are the same as your system device settings.• If you switched the audio output device during full screen sharing, cancel sharing and then share again.• If you changed the audio output device setting while sharing your screen and audio, stop sharing and try sharing again.• If using Windows, refer to the information in Appendix 1. |
| Japanese is not recognized. | Check whether the audio language setting is correct. If audio is set to "English" or "Chinese," all speech will be recognized as English or Chinese. Japanese speech will be regarded as either English or Chinese and not recognized, which may hinder accurate recognition/translation. |

| | |
|--|--|
| English is not recognized. | Check whether the audio language setting is correct. If audio is set to “Japanese” or “Chinese,” all speech will be recognized as Japanese or Chinese. English speech will be regarded as either Japanese or Chinese and not recognized, which may hinder accurate recognition/translation. |
| Chinese is not recognized. | Check whether the audio language setting is correct. If audio is set to “Japanese” or “English,” all speech will be recognized as Japanese or English. Chinese speech will be regarded as either Japanese or English and not recognized, which may hinder accurate recognition/translation. |
| Important note about Chinese | The recognition model used by Listening Assistant for Chinese was trained on standard Mandarin Chinese. |
| How can I improve recognition accuracy? | <p>Refer to “Improving speech recognition accuracy (phrase list function)” in this manual for information on the phrase list function. This can be used to improve the recognition accuracy of technical terms and other phrases.</p> <p>This function can be used to improve the recognition accuracy of some phrases.</p> <p>*Note that registering common phrases can actually reduce overall recognition accuracy.</p> |
| Automatic scrolling is not working while using | Automatic scrolling is enabled immediately after starting use, but automatic scrolling is disabled if you go back to the text display area even once to check the history. To re-enable automatic scrolling, you need to move to the latest text, so scroll to the bottom of the text display area with the mouse. |

Change history

| Version | Date | Location | Change |
|---------|---------------|-----------------------|--|
| 1 | Jun. 17, 2024 | - | <ul style="list-style-type: none"> Released first version of Listening Assistant Manual |
| 2 | Oct. 24, 2024 | Manual title and text | <ul style="list-style-type: none"> Revised title following official release of Listening Assistant |
| 3 | Nov. 13, 2024 | Manual text | <ul style="list-style-type: none"> Revised text following addition of “Japanese to English (one way)” language direction |
| 4 | Mar. 18, 2025 | Manual text | <ul style="list-style-type: none"> Revised text following implementation of phrase function |
| 5 | Mar. 24, 2025 | Manual text | <ul style="list-style-type: none"> Added description of password reset procedure |
| 6 | Jun. 30, 2025 | Manual text | <ul style="list-style-type: none"> Revised text following addition of “Japanese to Chinese (one way)” and “Chinese to Japanese (one way)” language directions |
| 7 | Sep. 11, 2025 | Manual text | <ul style="list-style-type: none"> Added description of the retry function in case of translation error |
| 8 | Jan. 26, 2026 | Manual text | <ul style="list-style-type: none"> Revised entirely with the upgrade |